

## Holz-Alu- Standard Fenster und Tür

Dämmwert:  
1-flg. 1230 x 1480,  
aus Kiefer o. Lärche  
Verglasung Ug 0,6  
Uf 1,15

**Uw 0,86**

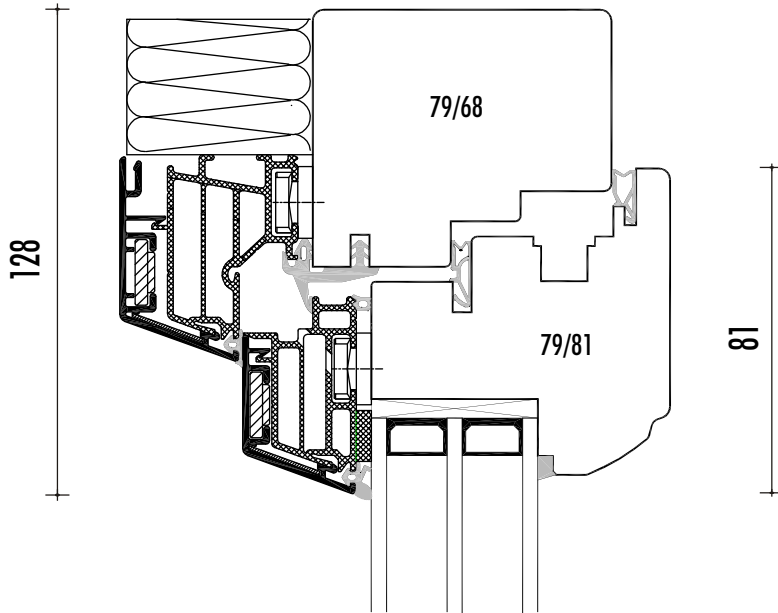

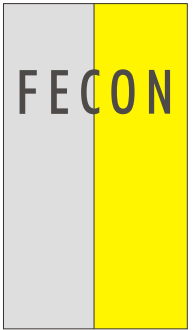
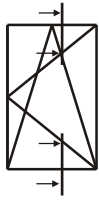

## Holz-Alu- Warmfenster u. Tür

Dämmwert nach DIN  
EN ISO 10077-3:  
1-flg. 1230 x 1480  
aus Kiefer o. Lärche  
Verglasung Ug 0,5  
Uf 0,95 / Psi- 0,035

**Uw 0,73**

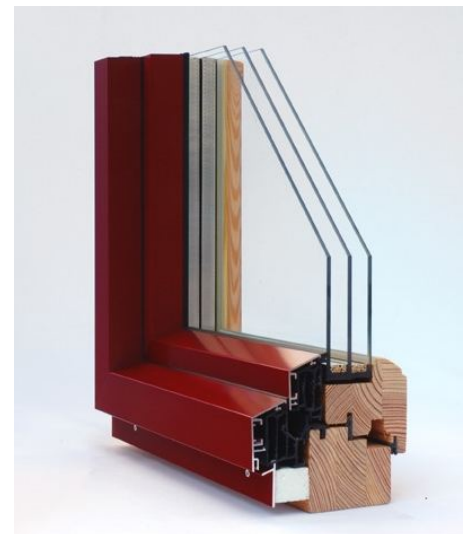
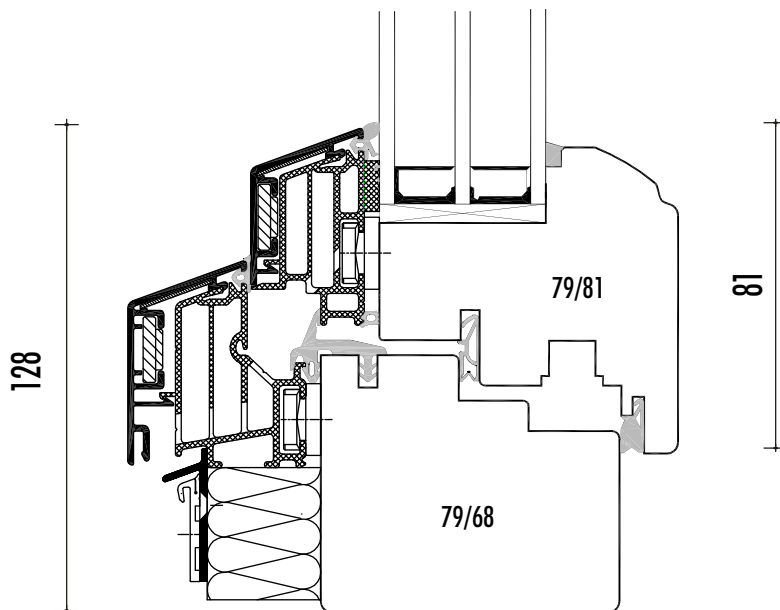

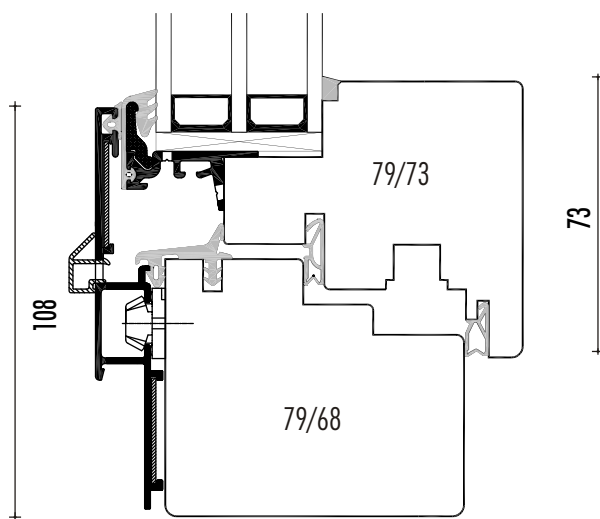
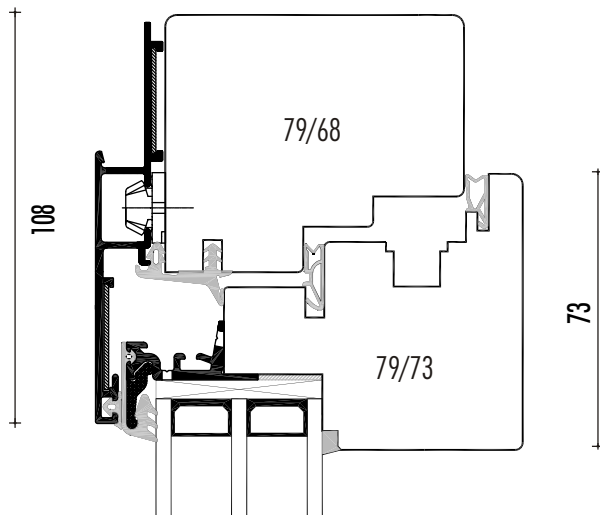
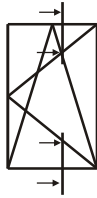

## Holz-Alu- Flügel verdeckt Fenster und Tür

Dämmwert nach DIN  
EN ISO 10077-3:  
1-flg. 1230 x 1480  
Verglasung Ug 0,6

**Uw 1,02**

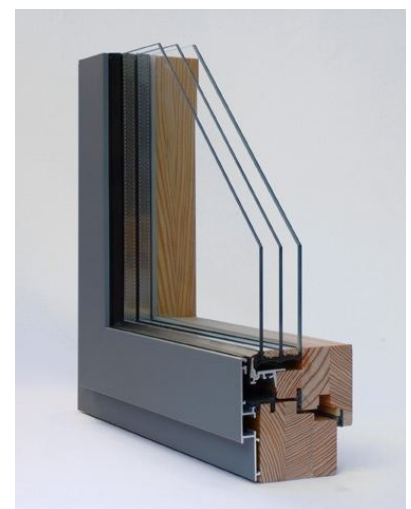

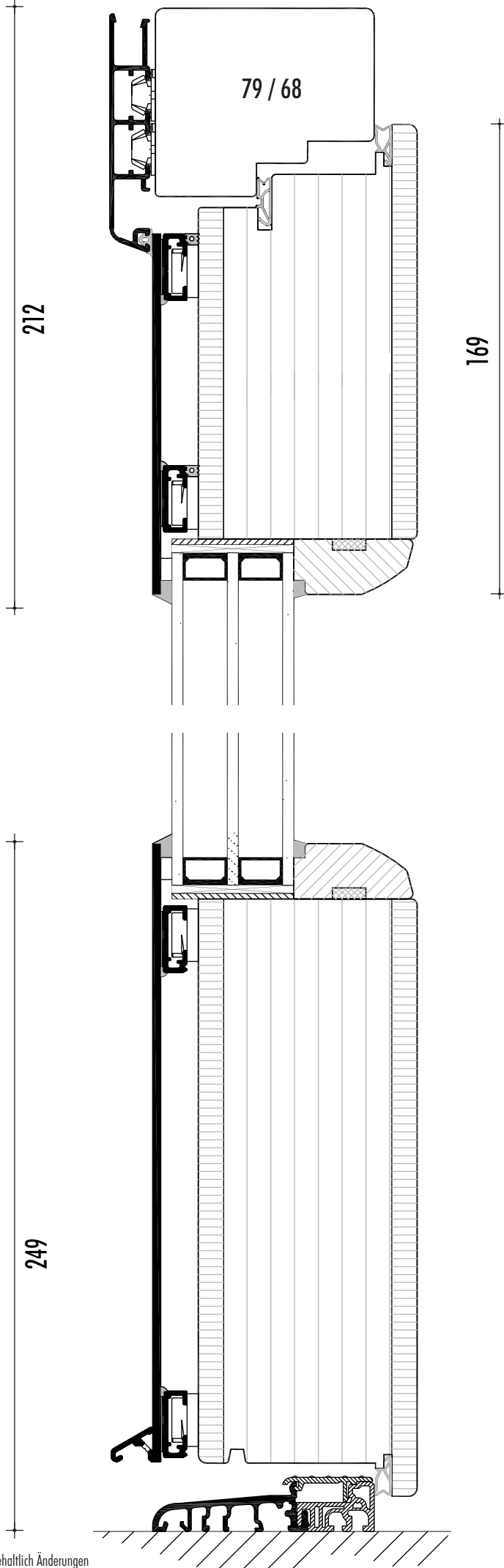

## Holz-Alu- Haustür

Dämmwert nach DIN  
EN ISO 10077-3  
bis 0,7 möglich